

SPAZIO R

LSR9250LWP SmartZ®

Taric 9405114090



Technical Standards

EN-60598-1, EN-60598-2-22, EN-62034, EN-303-446-1

Certifications



Functional Specifications

	Self-Contained
	Control system: Wireless SmartZ®
	AutoTest: Yes
	Type: Non-maintained / Maintained via third terminal
	Supply: 230V 50Hz<2.8W
	Non-maintained mode consumption: 0,9 W Maintained mode consumption: 2,8 W
	Emergency: 280 lm Mains: 170 lm
	Duration: 1 h Battery: 3.2V-1.5Ah LiFePO ₄
	Charging time: 12 h

Mechanical and Aesthetic Specifications

	Mounting: Ceiling Recessed
	Insulation: Class II
	IP42
	IK04
	Lamp: 1 x LED 3W
	LED color temperature: 4000 K
	Body material: Polycarbonate
	Finish: White RAL9003
	Diffuser / Optics: Polycarbonate Anti-panic Lens
	Working temperature: 0 / 40 °C
	Suitable for flammable surface: Yes

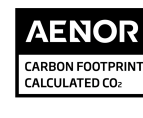

SPAZIO R LSR9250LWP

Installation characteristics

The luminaire has 3 mains supply inputs (L, L1, N) to enable / disable the maintained mode.

Luminaire made up of a spotlight + electrical equipment with batteries

Installation type:

- Recessed ceiling.

Double spring clips installation method.



Operating characteristics

This luminaire is compatible with the SmartZ® intelligent emergency lighting management system, designed to facilitate maintenance and installation control. Thanks to its 2.4 GHz wireless communication capability, it creates a dynamic mesh network that allows the connection of more than 10,000 luminaires without the need for any additional wiring.

The system simplifies real-time monitoring by issuing automated alerts in case of potential failures, eliminating the need for any manual inspections.

Additionally, it has the facility to integrate with other systems, both wired and wireless.

If not connected to the mesh network, the luminaire will default and operate in Autotest mode, automatically performing the detailed tests listed below.

Microprocessor controlled luminaire that performs periodic and automatic tests.







Functional test every **7 days**.



Duration test every **365 days**.

The test result is shown in the status indicator LEDs.

The luminaire has status LEDs, which indicates:

- | | | |
|---|--|--|
|  Green on: correct operation |  Orange on: incorrect battery or duration |  Both leds off: no power supply or total failure of the luminaire |
|  Green flashing: test in progress |  Orange flashing: functional failure | |

Accessories



CSZ003
SMARTZ CONTROL UNIT+ UPS
CSZ002+SAI002



ABX1741
ACC. PANEL REC. SPAZIO
PRINTING-RIGHT/LEFT 2-SIDED



ABX1841
ACC. PANEL REC. SPAZIO
PRINTING-UP 2-SIDED

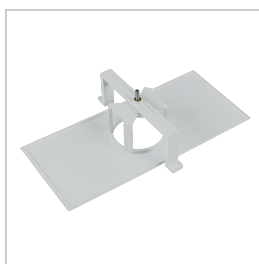

AMU8002
ACC. FRAME REC. SPAZIO
UNIVERSAL - WHITE

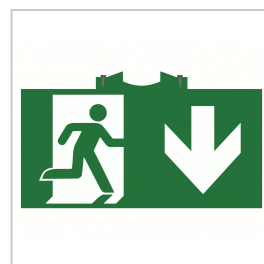

ABX1941
ACC. PANEL REC. SPAZIO
PRINTING-DOWN 2-SIDED

SPAZIO R LSR9250LWP

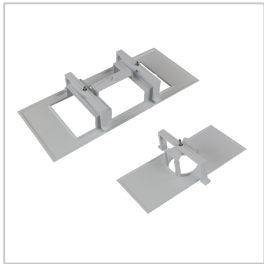

AMU8003
ACC. FRAME REC. SPAZIO
UNIVERSAL BIG HOLE - WHITE



ABX5441
ACC. PANEL REC. SPAZIO
PRINTING-LEFT SINGLE-SIDED



ABX5541
ACC. PANEL REC. SPAZIO
PRINTING-RIGHT SINGLE-SIDED

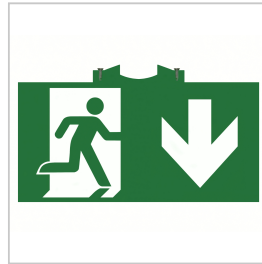

ABX5741
ACC. PANEL REC. SPAZIO
PRINTING-DOWN SINGLE-SIDED



ABX5841
ACC. PANEL REC. SPAZIO
PRINTING-UP SINGLE-SIDED

Spacing table

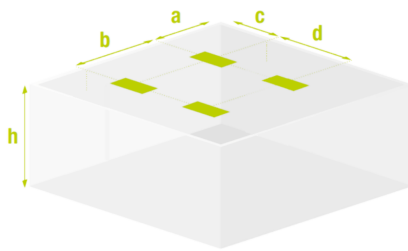

h	a	b	c	d
2 m	5,4 m	11,0 m	5,4 m	11,0 m
2.5 m	6,0 m	12,0 m	6,0 m	12,5 m
3 m	6,6 m	13,5 m	6,6 m	13,5 m
4 m	7,8 m	15,5 m	7,8 m	16,0 m
5 m	8,4 m	17,5 m	8,4 m	18,0 m

Spacing data calculated with no reflections and a maintenance factor of 0.9.

Compliant with the updated standard EN-1838:2024.

Minimum illuminance of 0.5 lux (anti-panic calculation).

The calculation of spacing distances is carried out considering the height of the light emission point, without taking into account the dimensions of the luminaire.

Photometric guide

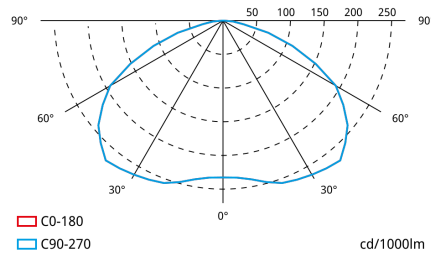

SPAZIO R LSR9250LWP

Weight (kg)



Product weight:

0.21 kg

Boxed product weight:

0.29 kg

Weight of box of 18 units:

5.52 kg



Dimensions (mm)

